



**SUFFOCATION DANGER: Keep out of reach of children
DO NOT USE AS LUGGAGE FOR AIR TRAVEL**

To Assemble the chest:

Open lid and flap E
to expose chest
interior

Pull side panel C up
from the bottom and
align with the chest
side panel.

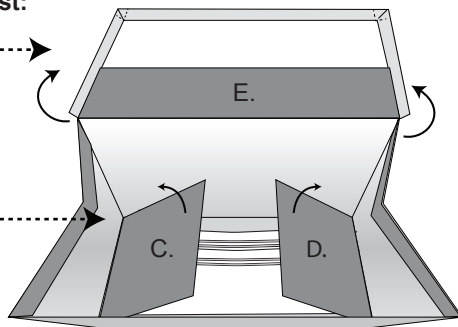

Then tuck panel C
under the top folded
edge to secure.

Repeat the process
with D on the other
side

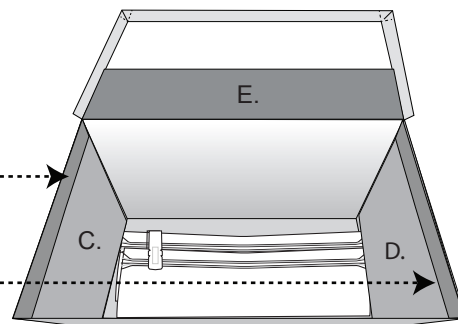

Fold back panel E
down and tuck under
side panels C and D
to secure.

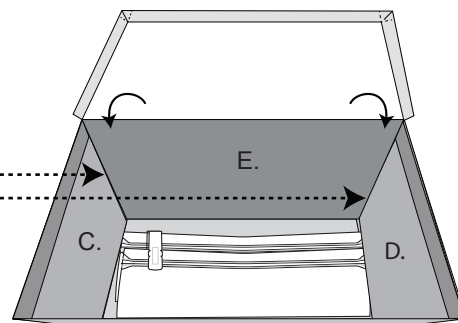

Note: Small Parts

A.



A. The plastic protectors resembling pen caps may be discarded. Their only purpose is to ensure that the Zip-Lock is not damaged during shipment.

B.

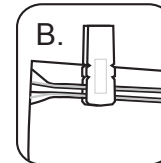

B. Do not discard the small white plastic slider. Use this tool to facilitate sealing the zip lock.

1.

Pack bag loosely so that the locking zipper closes easily



2.

Zip bag closed with white slider

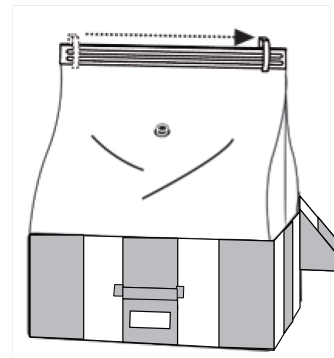

3.

Attach vacuum hose to valve on bag and turn on vacuum cleaner

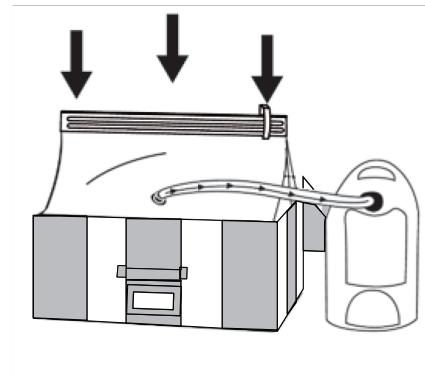

4.

Turn off vacuum as soon as the LED lights turn off

Buckle and adjust inside belts to secure the compression

Close chest lid

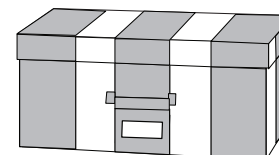

To open,
gently pull bag apart

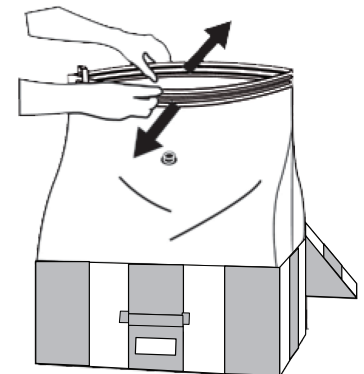

HTLV Valve Warning: Be sure to turn off the vacuum cleaner as soon as the blinking LED lights turn off. **For Compactor Assistance or Parts Call 1-800-446-3880**