

Assembly Instructions

5-Tier Folding Tower

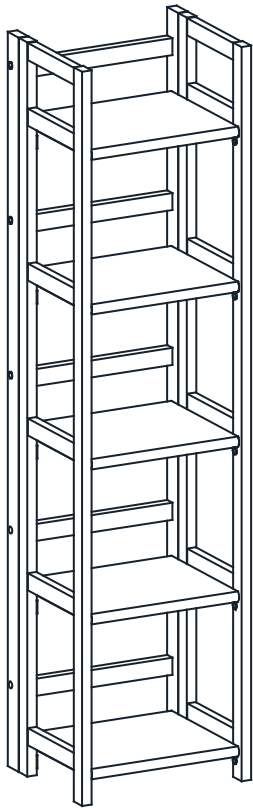

Step 1 : Gently lean the closed bookcase against the wall with a slight tilt to the back.

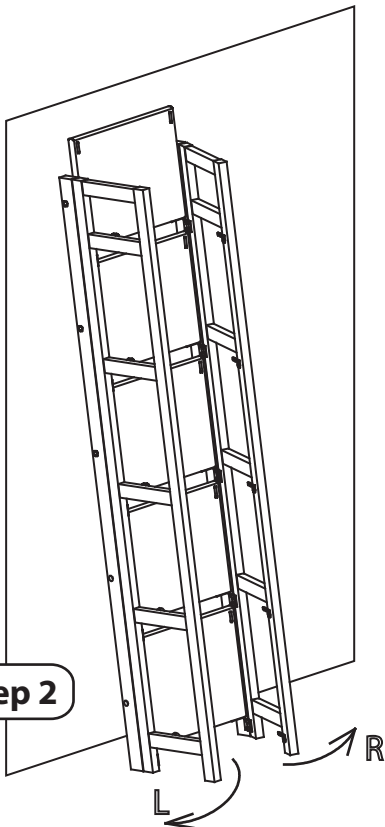
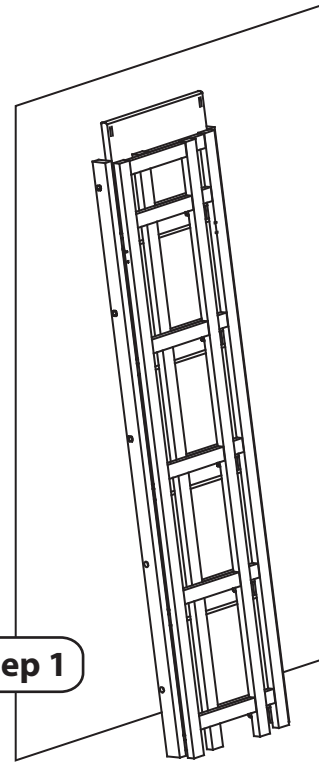

Step 2 : Open Left side panel (L) and Right Side Panel(R).

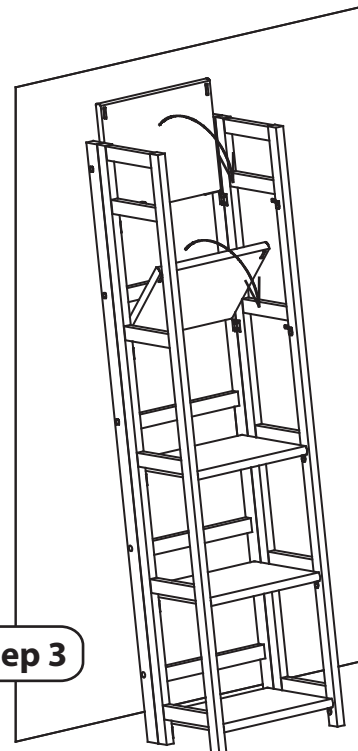

Step 3 : While they are opened lower each shelf. Make sure each shelf rests on the metal clip one on each side of the side panels. Stand the bookcase to its upright position.